

Database Mapper Excel Spreadsheet

Last Modified on 28 February 2023

EOL: An [end of life](#) announcement has been made for Database Mapper on February 28, 2023. See the [Solarwinds End of Life Policy](#) for more information.

In this article:

- [Excel Spreadsheet](#)
- [Adding Excel Spreadsheet](#)

Excel Spreadsheet

Solution Item Icon	Solution Item Description
	SolarWinds Database Mapper allows you to quickly develop a Lineage overview of your Excel Workbooks (*.xlsx) that contain SQL Server and Analysis Services data sources.

Adding Excel Spreadsheet

[🔗](#) **Additional Information:** You need to add a Database Mapper solution before adding an Excel Spreadsheet solution item. For more information about adding a solution, see the [Configuring Solutions](#) and [Database Mapper Solutions](#) articles.

Add an **Excel Spreadsheet** solution item to your Database Mapper solution by completing the following steps:

1. Select **Add** to add a new solution, or select **Open** to open an existing solution in the Database Mapper Configuration tool.

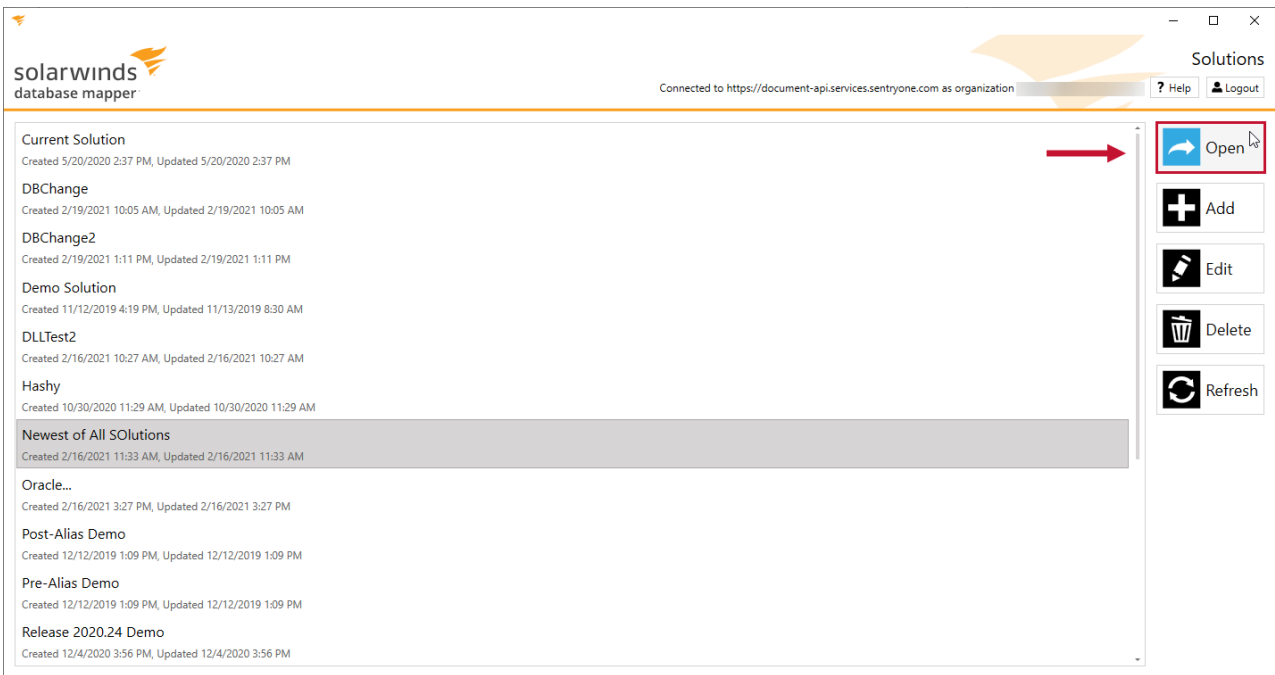

2. Select **Add** to open the **Add Solution** item window.

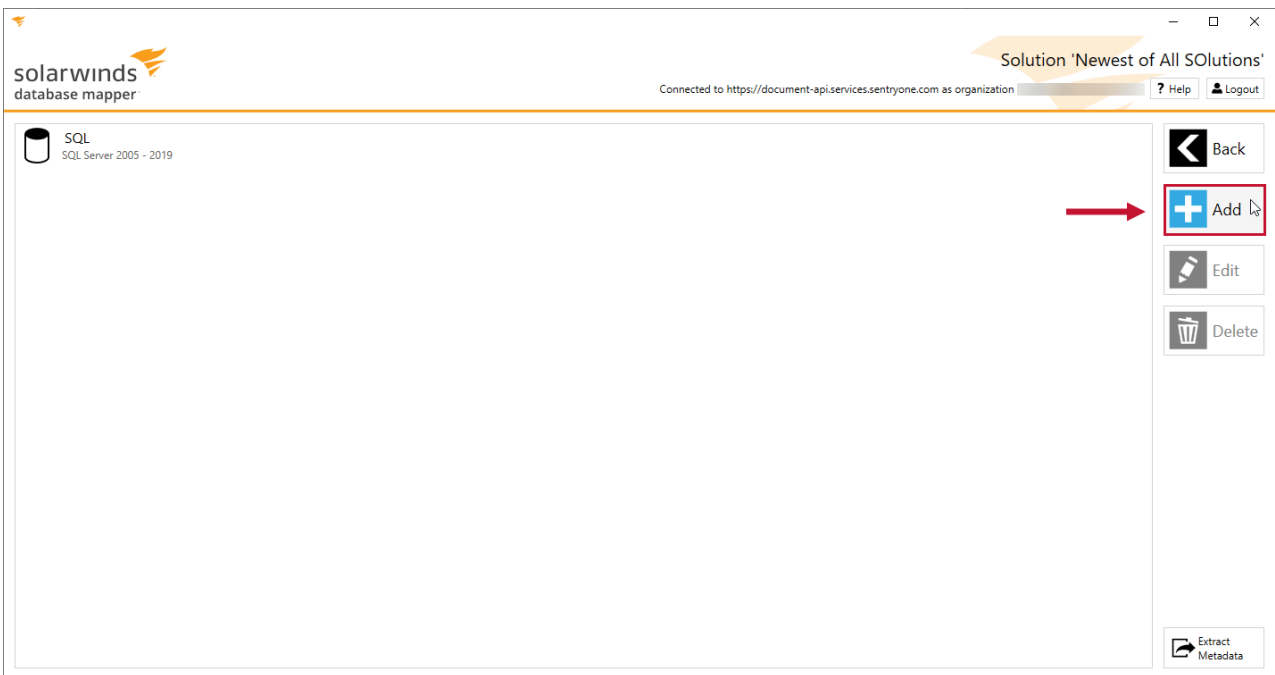

3. Enter an item name, then select **Excel Spreadsheet** from the **Source type** drop-down list.

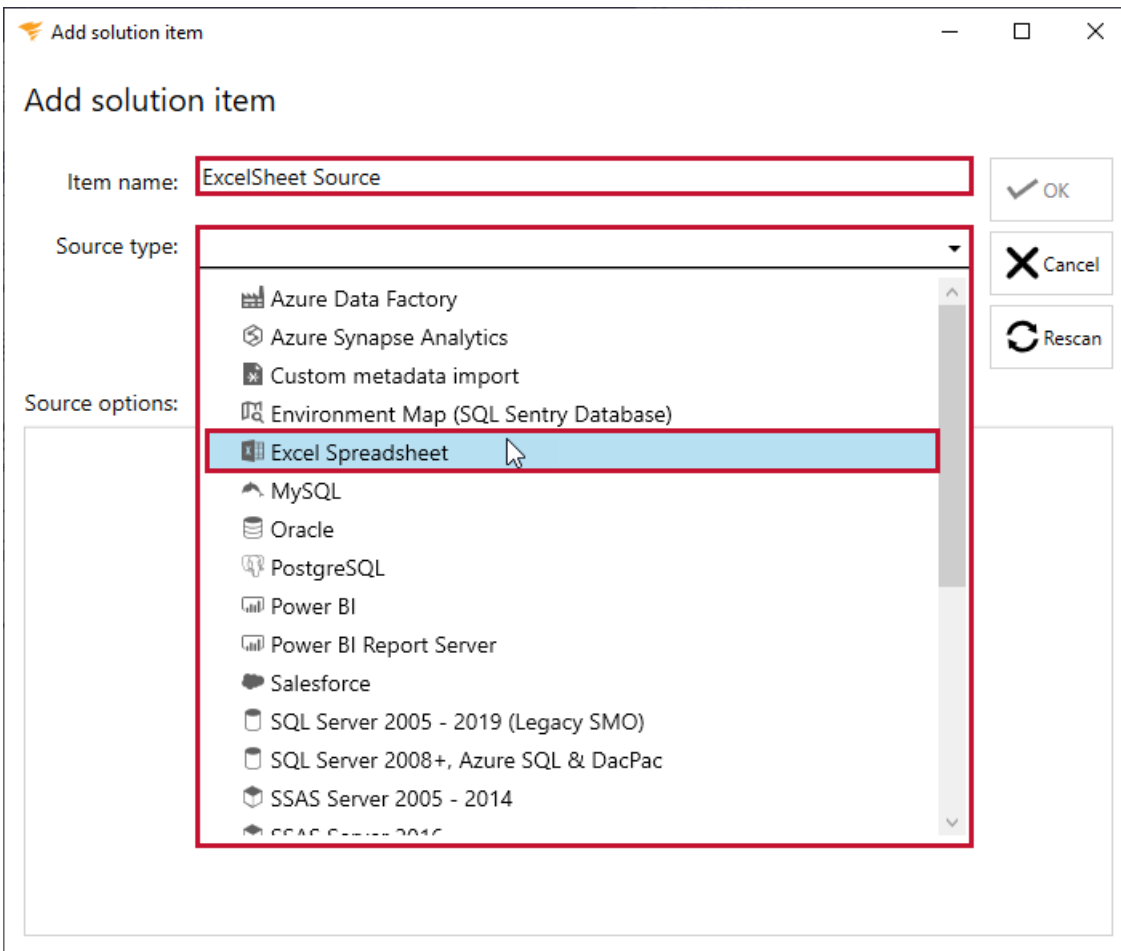

4. Select **File** to document an Excel Workbook on the file system, or select **Folder** to recursively document all Excel Workbook items within the selected folder.

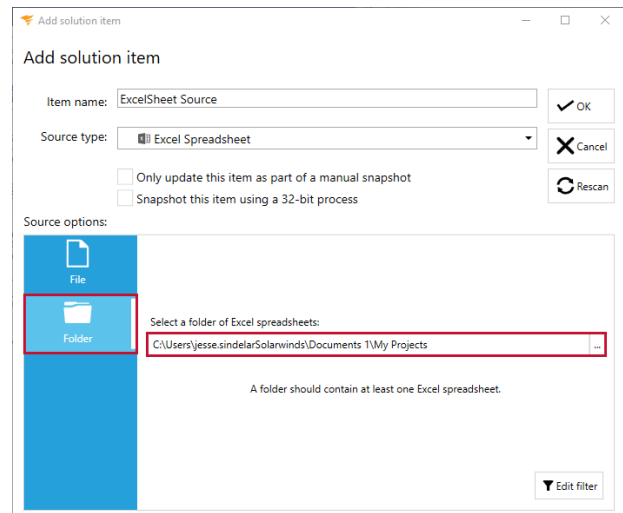
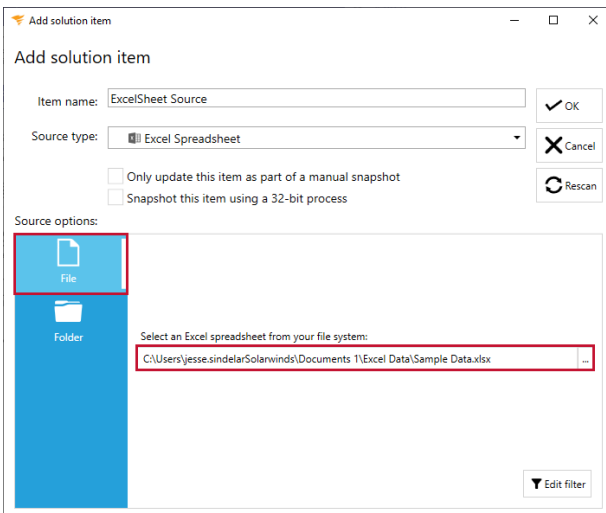

Note: Selecting the ellipsis launches the file explorer, allowing you to navigate to the desired file or file folder.

5. Select **OK** to add the Excel Spreadsheet Solution item to your Database Mapper solution.

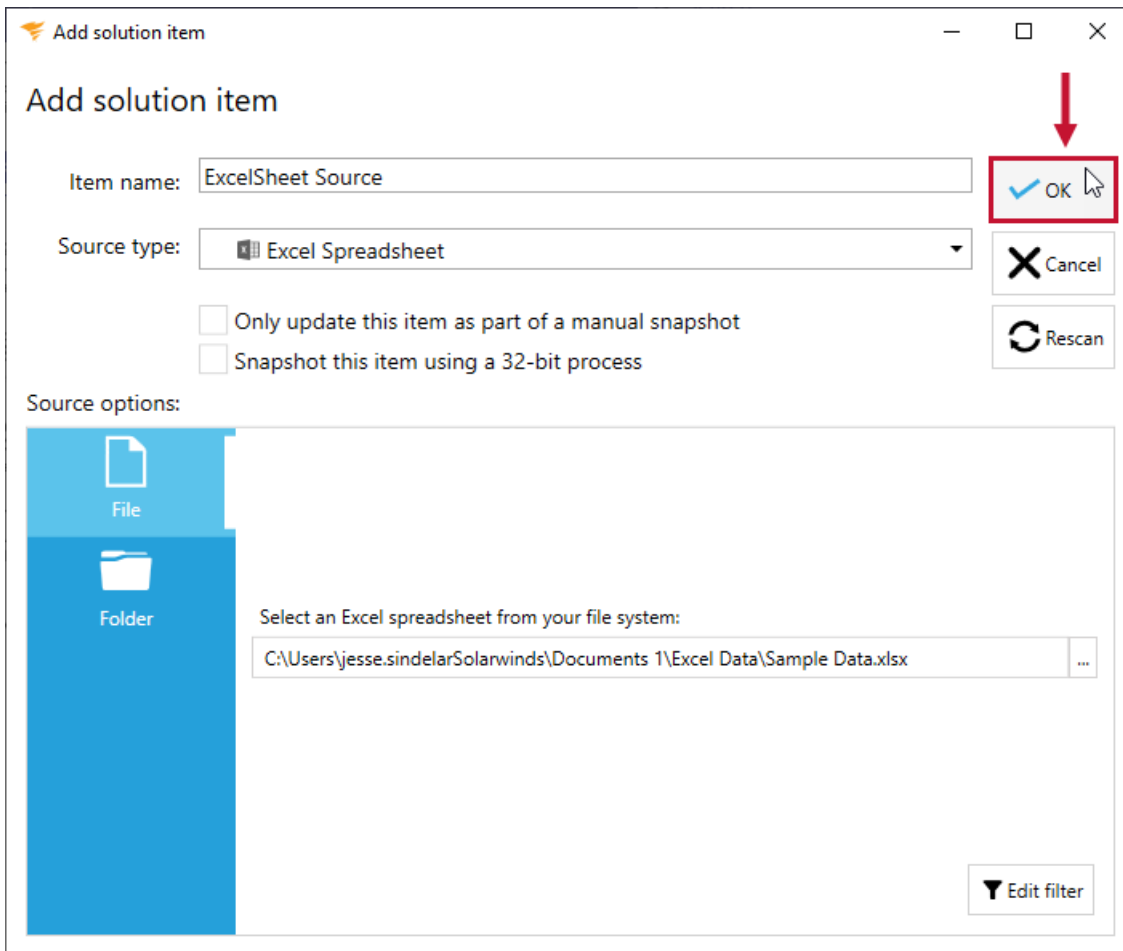

Additional Information: You need to take a snapshot of your solution and Excel Spreadsheet solution item before viewing any documentation or lineage. For more information about taking a snapshot, see the [Generating Documentation](#) and [Scheduling a Snapshot](#) articles.

After adding a solution with your Excel Spreadsheet solution item, and taking a snapshot, you are ready to view your documentation.

Additional Information: For more information about the Documentation tab in Database Mapper, see the [Documentation](#) article.

After adding a solution with your Excel Spreadsheet solution item, and taking a snapshot, you are ready to view your solution's lineage within the environment.

Additional Information: For more information about the Lineage tab in Database Mapper, see the [Lineage](#) article.